

BOLLARD
BOLRECOP

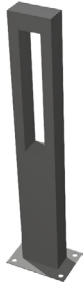

DIMENSIONS:
4" W x 2" D x 27" H
BASE - 6.5" x 4.5"

Custom Heights Available

| | |
|--------------|--|
| Project: | |
| Location(s): | |
| Type: | |
| Qty: | |
| Date: | |

PRODUCT SPECIFICATIONS

Description:
A Slim Style Rectangle Bollard That Allows An Unique Light Output

Materials:
Aluminum Housing

Finish:
Powder Coated

Lens:
Clear Polycarbonate

LED:
Integrated LED Array

Listing:
Wet List to Meet UL 1598 Standard

Driver Info:
120/277V

Installation Information:
Install by Qualified Electrician

Warranty:
2 Years From Date of Shipment

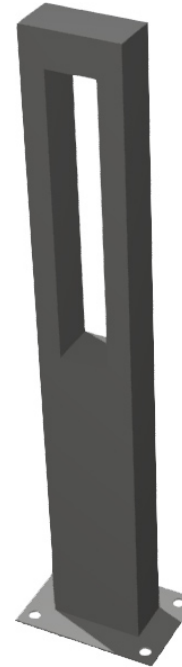

ORDER INFORMATION
Call Factory For Fluorescent Options

| MODEL | FINISH | WATTAGE | KELVIN | OPTIONS |
|--------------------------|--|--|---|---|
| Model BOLRECOP | Finish DB - Dark Bronze BL - Black AS - Anodized Silver WH - White CC - Custom Color | Wattage LED10 - 10W LED 1000 Lms | Kelvin 30 - 30K 35 - 35K 40 - 40K 50 - 50K | Options DIM0-10V - 0-10V Dimmable PC - Photocell |