

Standard Product Specifications

Materials:

Spun Aluminum Housing

Finish:

Powder Coated

Lens:

Clear Polycarbonate

LED:

Integrated LED Array

Listing:

Wet List to Meet UL 1598 Standard

Driver Info:

120/277V

Installation Information:

Install by Qualified Electrician

Warranty:

2 Years From Date of Shipment

DIMENSIONS:

18"Dia. x 15"H

(Does not Include Arm Dimensions)



SBELL Shown Mounted on DSA4 Arm
(View Additional Mounting Options on the Next Page)

MODEL	FINISH	WATTAGE	KELVIN	TYPE	OPTIONS
Model SBELL	Finish DB - Dark Bronze BL - Black AS - Anodized Silver WH - White CC - Custom Color	Wattage LED50 - 50W LED 5000 Lms LED80 - 75W LED 8000 Lms LED100 - 75W LED 10000 Lms LED120 - 95W LED 12000 Lms LED150 - 100W LED 15000 Lms <i>*Higher Outputs Available - Contact Factory for Details</i>	Kelvin 30 - 30K 35 - 35K 40 - 40K 50 - 50K	Type II - Type II IIM - Type II Medium III - Type III IIIM - Type III Medium IV - Type IV V - Type V VSQ - Type V Square	Options DIM - 0-10V Dimmable HSS - House Side Shield WM - Wall Mount CBLH - Cable Hanger System DSA1-190/2180 - DSA1 One Head @ 90 Degrees or Two Heads @ 180 Degrees DSA3-190/2180 - DSA3 One Head @ 90 Degrees or Two Heads @ 180 Degrees DSA4-190/2180 - DSA4 One Head @ 90 Degrees or Two Heads @ 180 Degrees GN1-190 - Gooseneck Type 1 - 1 Head @ 90 Degrees GN2 - 190/2180 - Gooseneck Type 2 - 1 Head @ 90 Degrees or 2 Heads @ 180 Degrees

Mounting Arm Options

DSA1

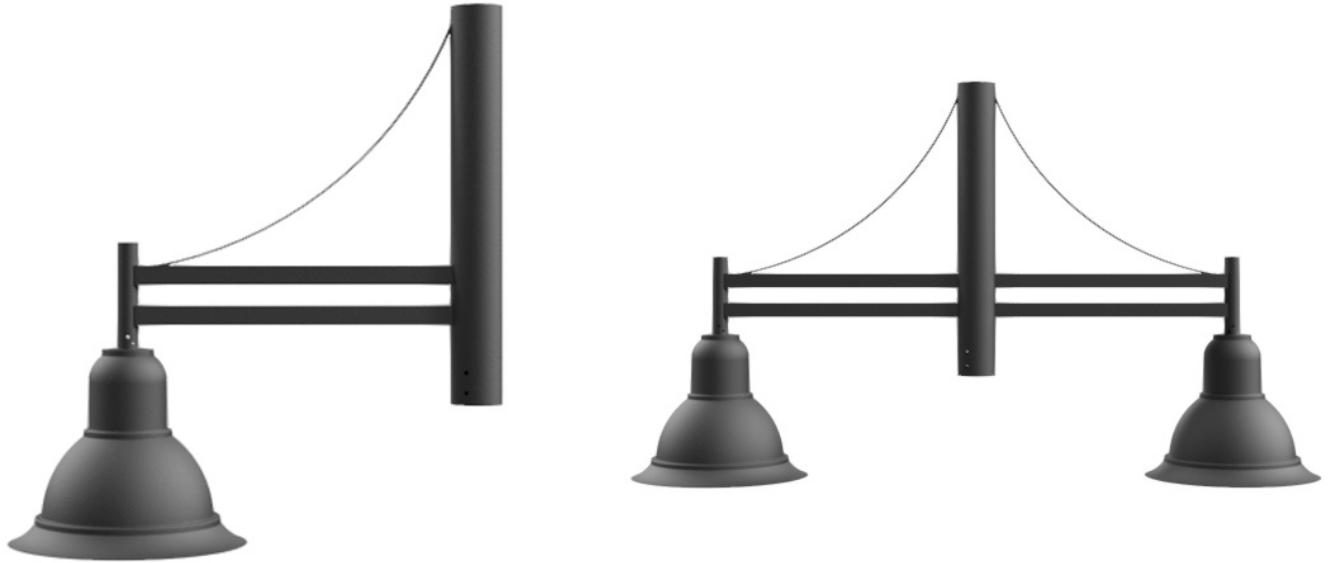

Dimensions:

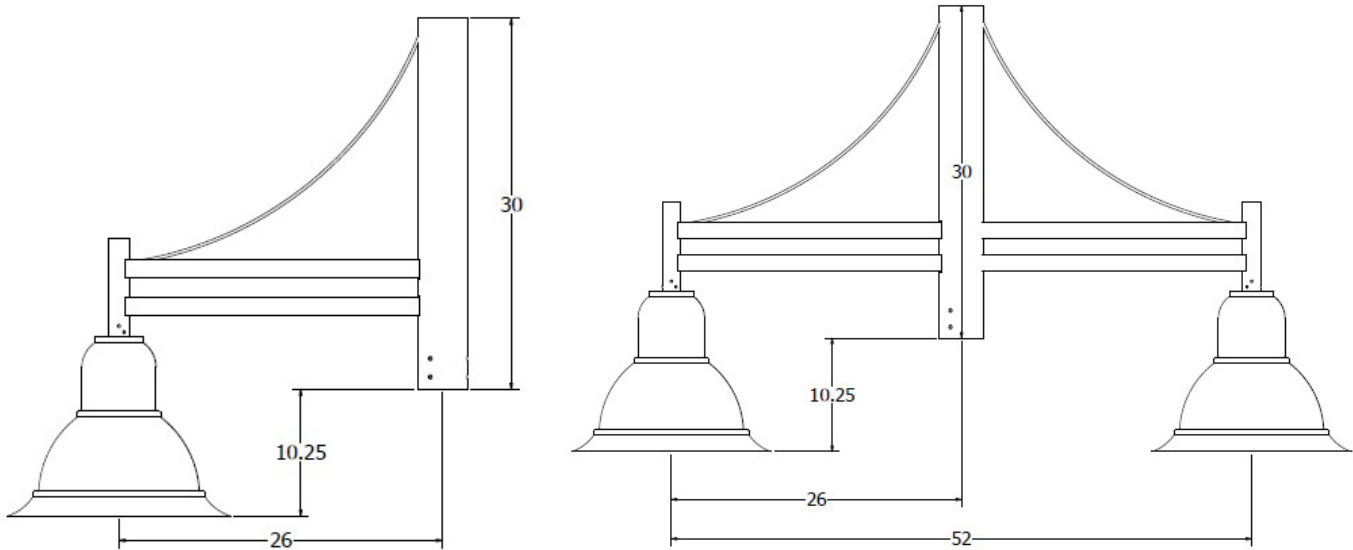

Mounting Arm Options(Continued)

DSA3

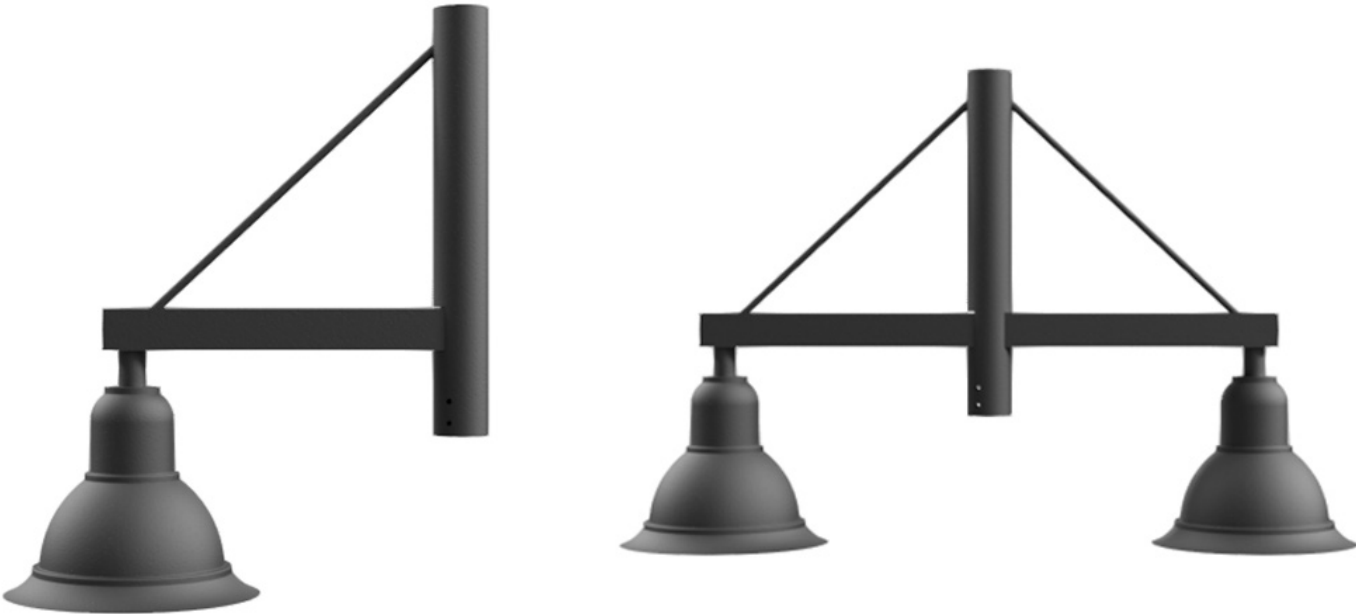

Dimensions:

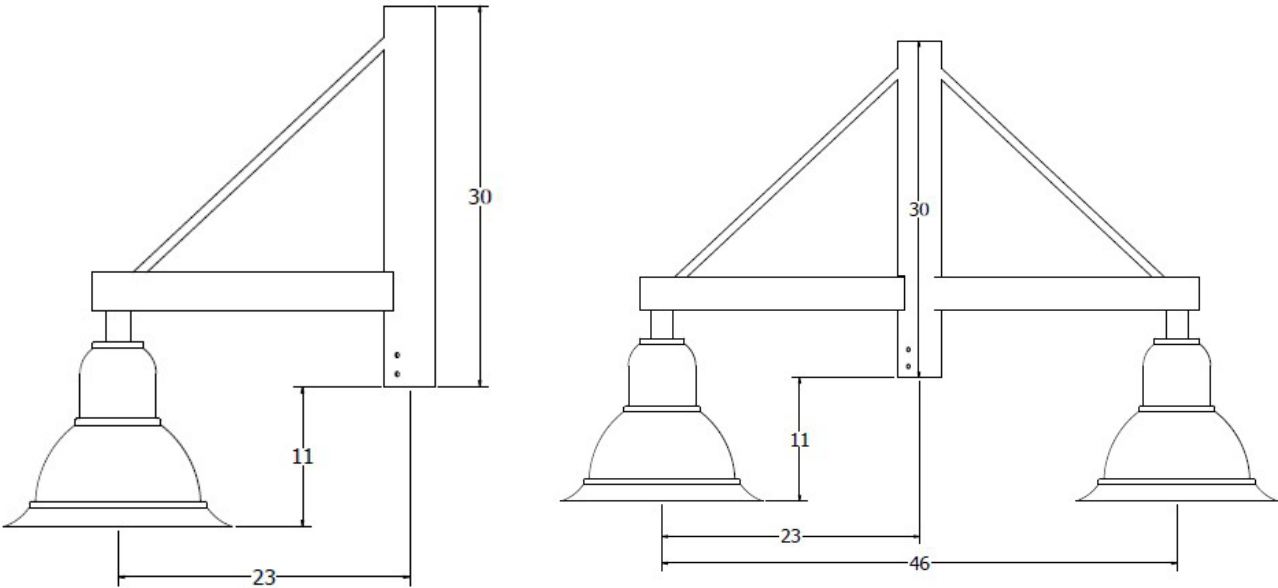

Mounting Arm Options(Continued)

DSA4



Dimensions:

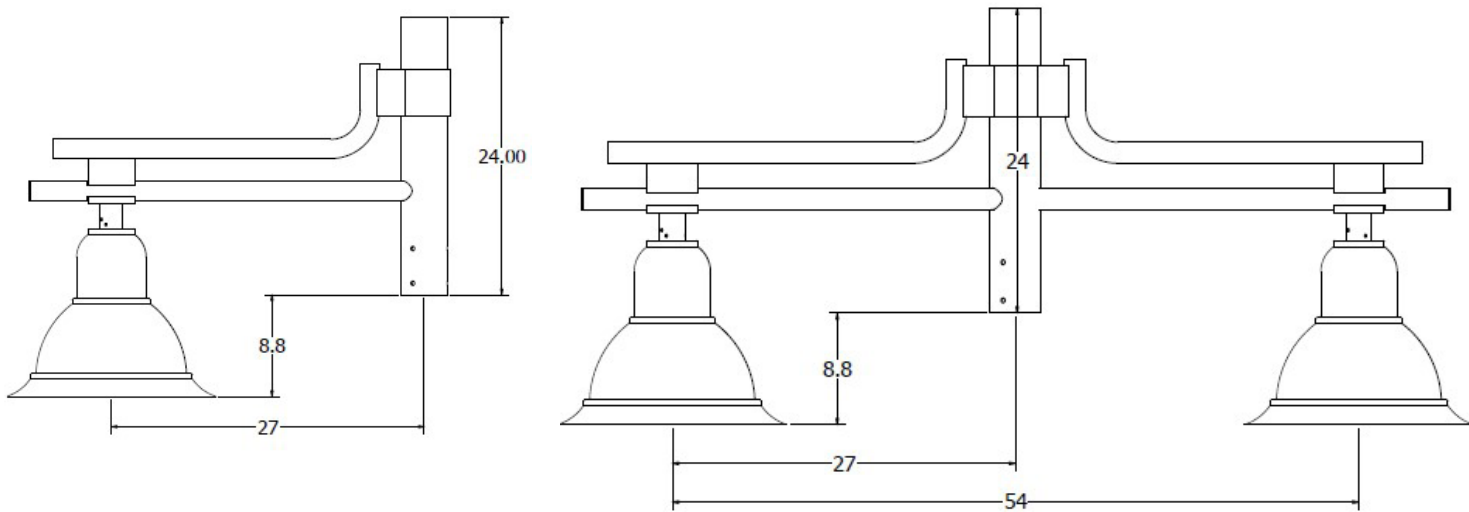

Mounting Arm Options(Continued)

Gooseneck 1

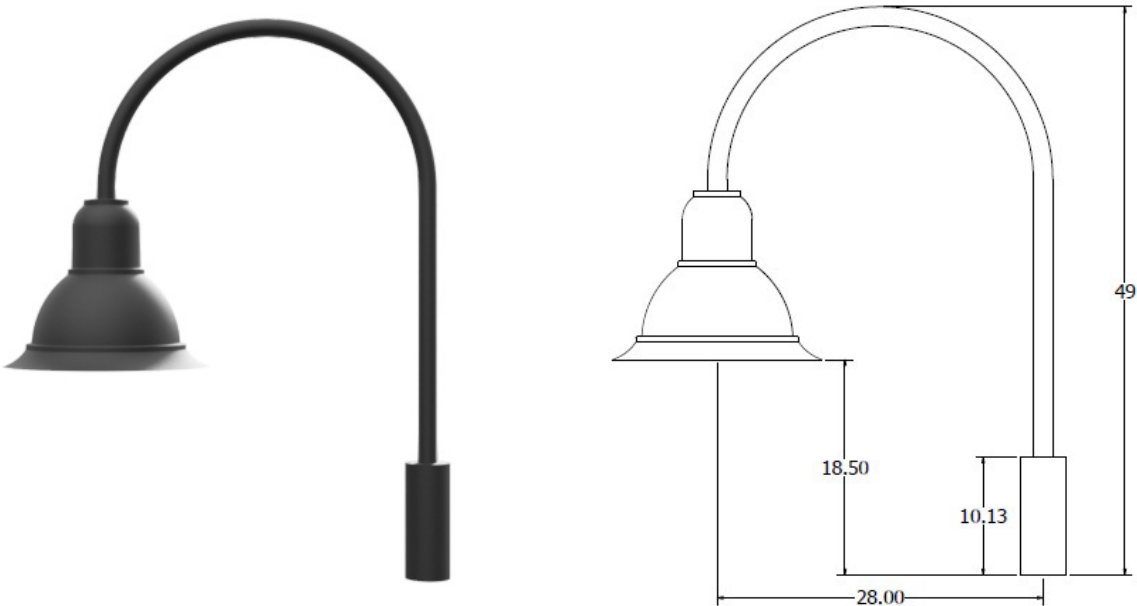

Gooseneck 2



1 Head @ 90 Degrees

2 Heads @ 180 Degrees

Mounting Arm Options(Continued)

Dimensions:

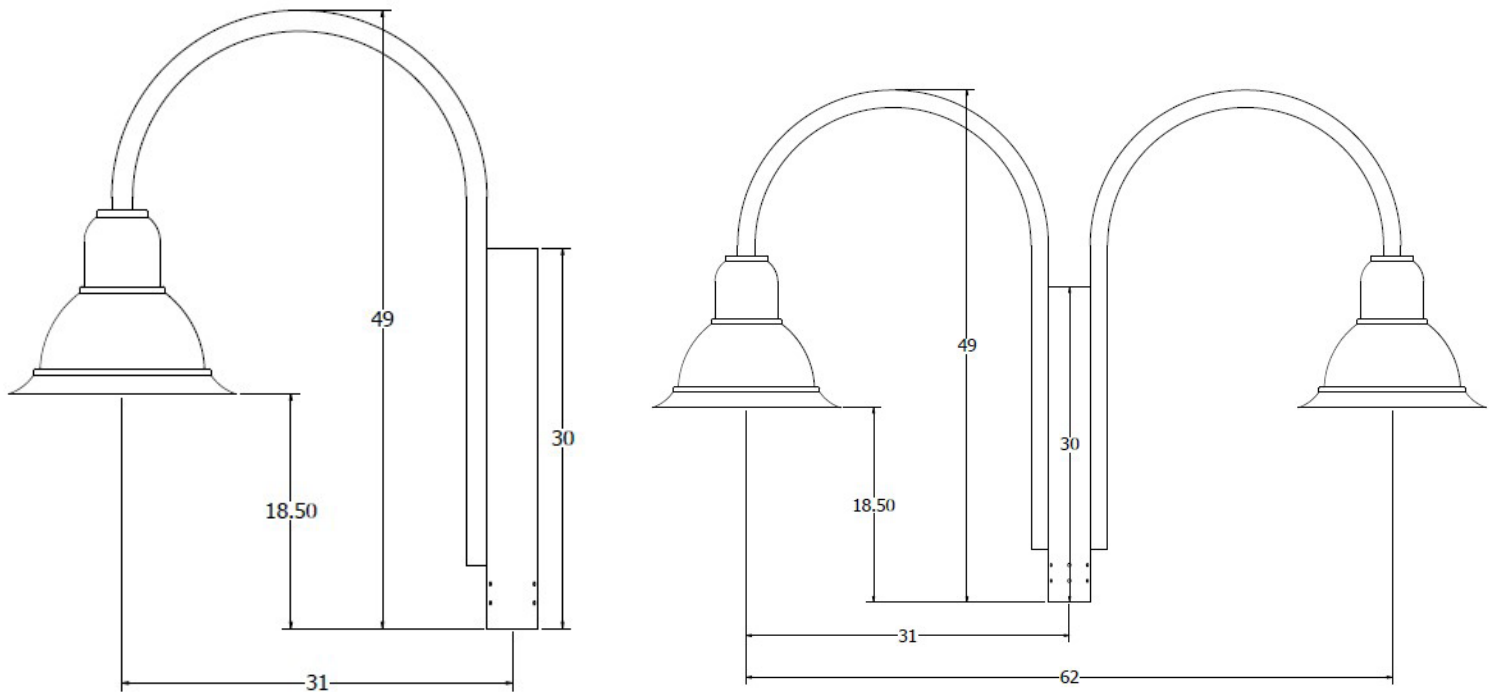

Please Indicate Mounting Preference When Ordering

EX. Part Number: **SBELL-BL-LED40-40-DSA1-190**

****Divine Lighting is not responsible for inconsistencies between poles, fixtures, and parts produced by different manufacturers, and cannot guarantee proper fitting between such components.**

MODEL	FINISH	WATTAGE	KELVIN	TYPE	OPTIONS
Model SBELL	Finish DB - Dark Bronze BL - Black AS - Anodized Silver WH - White CC - Custom Color	Wattage LED50 - 50W LED 5000 Lms LED80 - 75W LED 8000 Lms LED100 - 75W LED 10000 Lms LED120 - 95W LED 12000 Lms LED150 - 100W LED 15000 Lms LED200 - 150W LED 20000 Lms *Higher Outputs Available - Contact Factory for Details	Kelvin 30 - 30K 35 - 35K 40 - 40K 50 - 50K	Type II - Type II IIM - Type II Medium III - Type III IIIM - Type III Medium IV - Type IV V - Type V VSQ - Type V Square	Options DIM - 0-10V Dimmable HSS - House Side Shield WM - Wall Mount CBLH - Cable Hanger System DSA1-190/2180 - DSA1 One Head @ 90 Degrees or Two Heads @ 180 Degrees DSA3-190/2180 - DSA3 One Head @ 90 Degrees or Two Heads @ 180 Degrees DSA4-190/2180 - DSA4 One Head @ 90 Degrees or Two Heads @ 180 Degrees GN1-190 - Gooseneck Type 1 - 1 Head @ 90 Degrees GN2 - 190/2180 - Gooseneck Type 2 - 1 Head @ 90 Degrees or 2 Heads @ 180 Degrees